

ENGKY

DESIGN SDN BHD (1000561-H)

**No. 8 , Jalan Mas 2, Kinrara Mas, 58200, Bukit Jalil, Kuala Lumpur.
Tel: 603 – 8076 9760 Fax: 603 – 8076 9761 Email: engkydesign@gmail.com**

PROFILE

Engky Design is a professional landscape consulting firm who believes in balance of forms, function ,architecture and the environment.

Engky Design is the aspiration of two landscape designers with more than 10 years of design experience in the market. We express our work through art and blend our art with the environment .

We aims to create meaningful and unique landscape design to each site according to the essence of their context and brief history.

We always strive to the pursuit of excellence service to the client. Complementing the design talent and experienced technical expertise, we offer fully integrated landscape services to create innovative and cost –effective design solutions that are executed with a high standard of uncompromising quality and dependability.

Professional Services:

- Master planning
- Landscape architecture
- Urban design
- Submission to local authority

ABOUT THE PARTNERS

KHOO ENG KEE

Graduated from University Putra Malaysia in Bachelor of Landscape Architecture. Has worked as landscape architect in Urban Design Sdn. Bhd. for 2 years before joining Aroma Tropics in year 2003. He is the founder for Symbios Design in year 2003 which is currently known as Engky Design.

Corporate Member for Institute of Landscape Architects Malaysia (AILAM no 0200206)

LEE PING CHEE

Graduated from University Putra Malaysia in Bachelor of Landscape Architecture. Has worked as landscape architect in KRB for 4 years and TA Properties as in-house landscape architect for 6 years before joining Engky Design in year 2010.

Corporate Member for Institute of Landscape Architects Malaysia (AILAM no 0300214)

PICTURE PROFILE

ENGKY DESIGN SDN BHD



Hotel & Resort
PHILEA RESORT & SPA, AIR KERUH

ENKYE DESIGN SDN BHD



Hotel & Resort
PHILEA RESORT & SPA, AIR KERUH

ENGKY DESIGN SDN BHD



Hotel & Resort
PHILEA RESORT & SPA, AIR KERUH

ENGKY DESIGN SDN BHD



Clubhouse
THE PEAK BUKIT PRIMA, CHERAS

ENGKY DESIGN SDN BHD

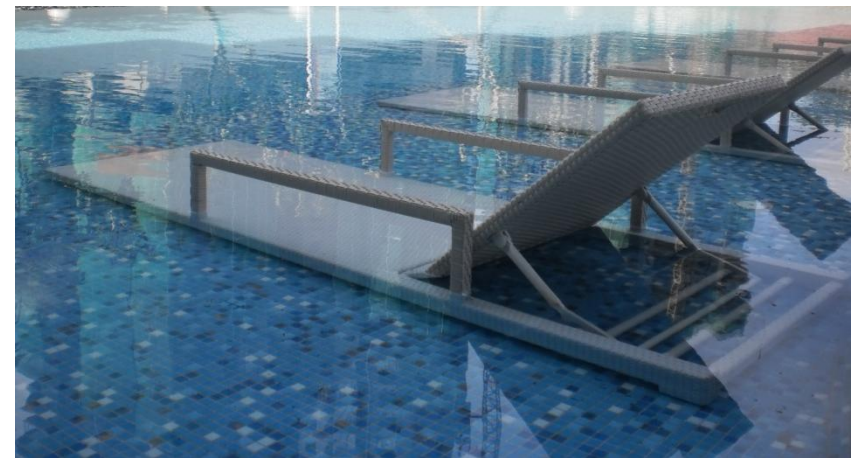

Condominium & Serviced Apartment
KIARA 3, MONT KIARA



Condominium & Serviced Apartment
CASA INDAH II, TROPICANA

ENK KY DESIGN SDN BHD



Condominium & Serviced Apartment
AMPANG BOULEVARD, AMPANG

ENGKY DESIGN SDN BHD



Condominium & Serviced Apartment
HERON RESIDENCY , PUCHONG

ENGKY DESIGN SDN BHD



Gated Residence Development
VILLA GREEN 3A, TROPICANA



Gated Residence Development
BAYU SEGAR , CHERAS

ENK KY DESIGN SDN BHD



Gated Residence Development
BAYU SRI BINTANG, KEPONG

ENGKY DESIGN SDN BHD

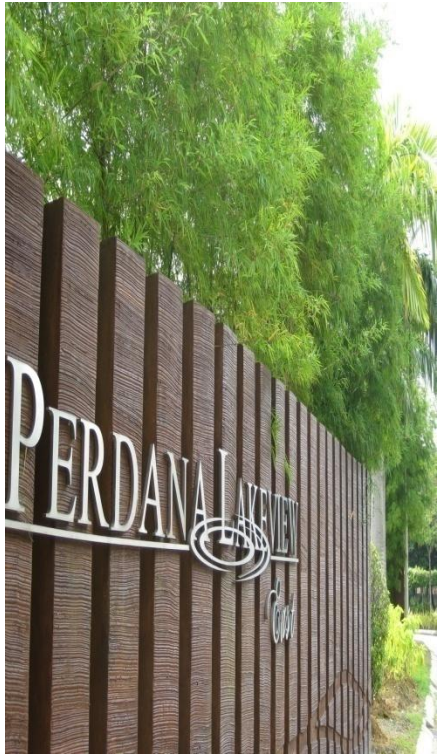

Gated Residence Development
**PERDANA LAKEVIEW
EAST & WEST, CYBERJAYA**

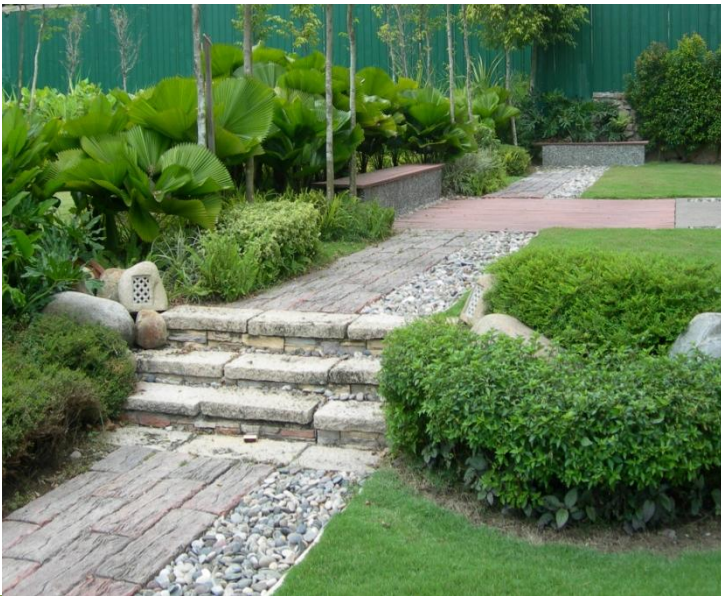

Bungalow & Show Units
VILLA GREEN 3A, TROPICANA

ENGKY DESIGN SDN BHD



Bungalow & Show Units
BAYU SEGAR , CHERAS

ENGKY DESIGN SDN BHD



Bungalow & Show Units
19 RESIDENCY, PUCHONG.



Bungalow & Show Units
SRI CARCOSA, SEREMBAN.

ENGKY DESIGN SDN BHD

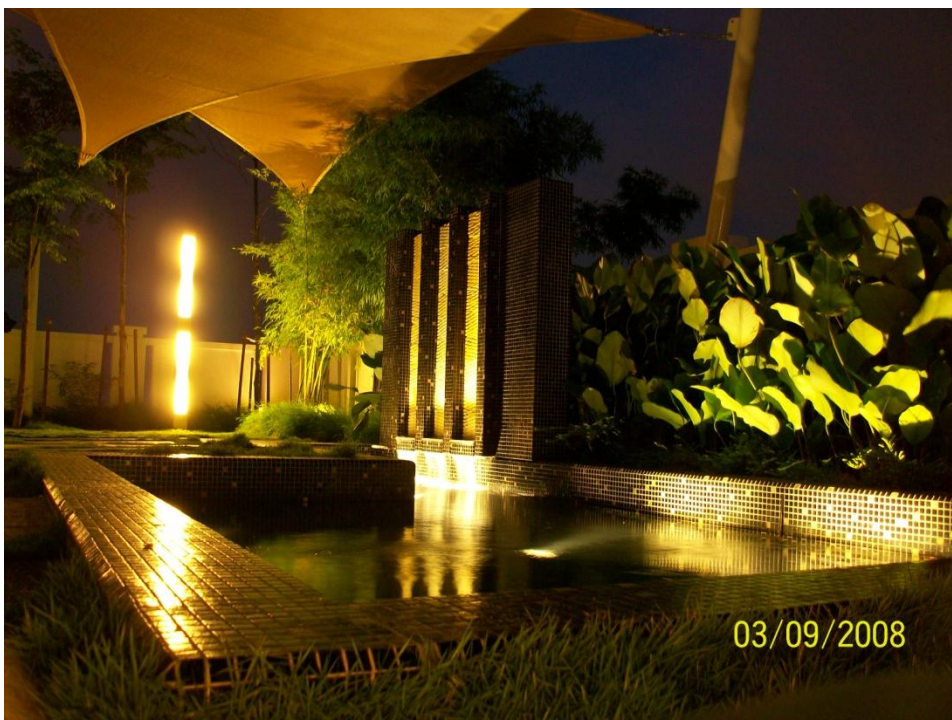

Bungalow & Show Units
BAYU SRI BINTANG, KEPONG.

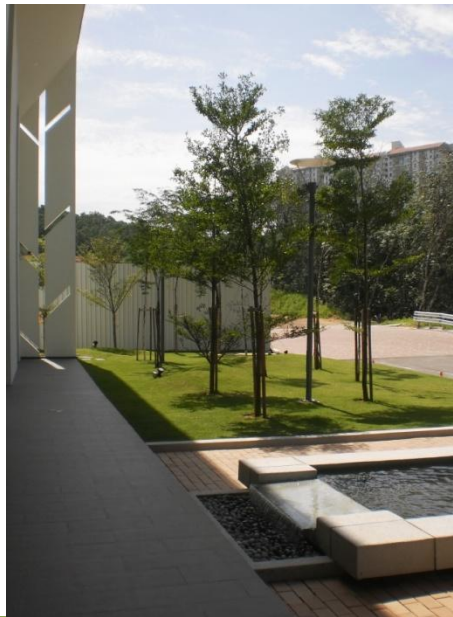

Bungalow & Show Units
SANDERSON, SERDANG.

ENGKY DESIGN SDN BHD

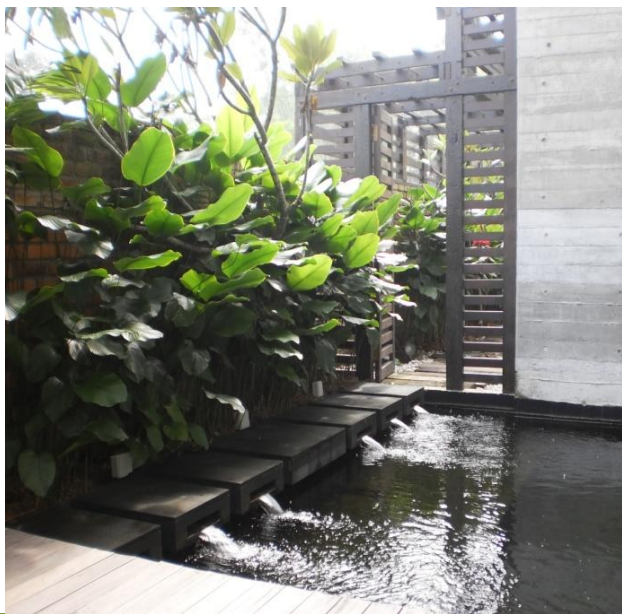

Bungalow & Show Units
MR WONG'S BUNGALOW, TMN YARL.



Commercial Development & SPORT COMPLEX
SUNSURIA AVENUE, DAMANSARA.



Commercial Development
KAJANG WALK, KAJANG.

ENGKY DESIGN SDN BHD

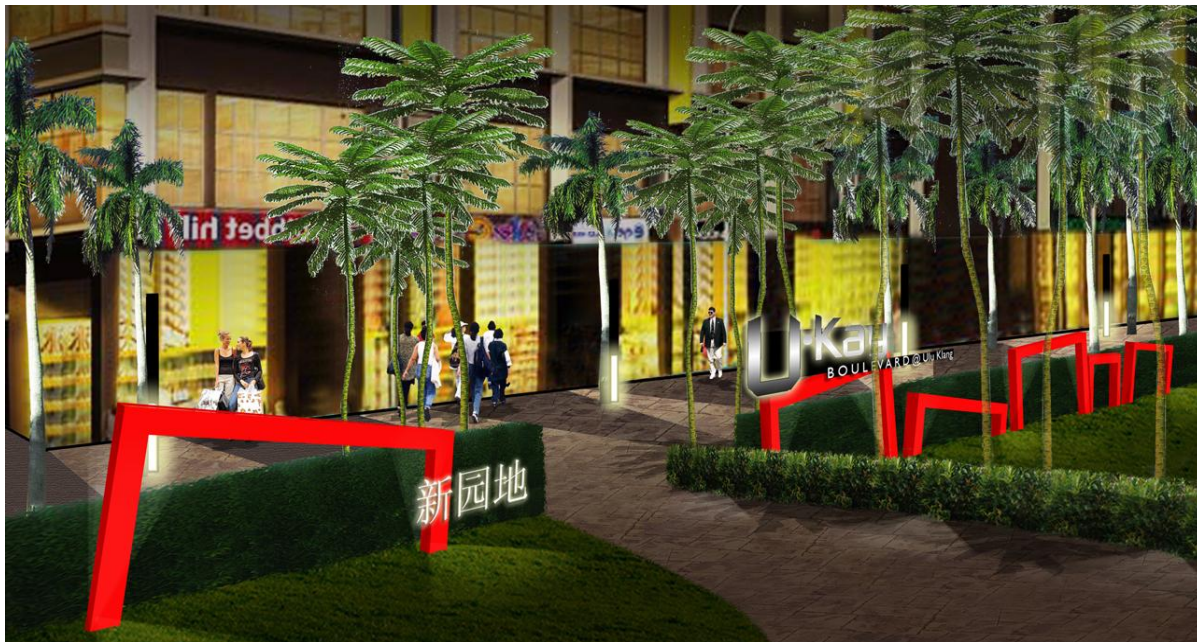

Commercial Development
UKAY BOULEVARD, ULU KLANG.

ENGKY DESIGN SDN BHD



Landscape Masterplan
PELANGI SEMENYIH 2.

PUBLISHED ARTICLES

ENGKY DESIGN SDN BHD



green fingers

a touch of zen

Clean, pure and simple - the fundamental qualities of Zen gardens generally radiate a certain aura of tranquillity and elegance.

TEXT TONG CHIN THING PHOTOS SYMBIOS DESIGN

Sometimes understated otherwise elaborate, gardens are very much a personal and intimate part of our daily lives. It is an expression of our soul that we portray to the public, whether we love the frolicking fashion of freesias that splashes colours all over or neatly mowed lawns with perfectly manicured hedges.

Rejuvenating and usually maintaining the traditional principles of excellence and balance, Zen gardens are often reflections of a contemplative mind. Originating from Japan, 'Zen' comes from the word 'Zazen', meaning 'monk'. It was contrived mainly in the courtyard of a temple with the sole purpose of recreating a peaceful and calm setting to complement the temple ambience.

Clean, pure and simple - the fundamental qualities of Zen gardens generally radiate a certain aura of tranquillity and elegance.



Articulation 1 - The flat expanse of raked gravel can be articulated as clouds with boulders placed halfway out of the raked gravel to be portrayed as mountain peaks surrounded by the clouds like in the Chinese paintings. (These boulders are always in odd numbers, as it is believed to be easier to arrange.) The plants are representative of the vegetation around the mountains. Some believe that the Japanese garden was a joke created by a Japanese who was amused by the Chinese paintings.

Articulation 2 - The raked gravel depicts the rippled surface of the ocean which is formed by the idea, inspiration or thought that emerges from the calm ocean articulated through meticulous placement of boulders.

Zen gardens are almost always sparsely decorated with plants. Hedges are planted as a background and precisely pruned to shape and the leave size is preferably small to preserve the clean appearance. Some good examples are the *Davallia Repens* 'variegated' and the *Ficus Spp.* For ground covering that interweaves by the boulder island, various *Ferns*, *Dwarf Junipers* and *Bamboo Grass* are great choices. As such there are no massive and colourful planting in a Zen garden.

Despite the general sense of simplicity and serenity, the Zen garden requires discipline when it comes to maintenance. All that weeding, pruning and raking should become part of the daily routine, like that of the Zen gardens tended by the monks in the temples.

These are the elements that demand the most attention in a Zen garden:

- 1. Cleanliness of the garden. Even a tiny little bit of weed will spoil the entire effect of a Zen garden.
- 2. Raking patterns. The pattern of the raking must look fresh all the time. Which means the gardener should carefully tend to the raking in an almost religious ritual. Even after a rainfall, the gravel should be raked to regain its original design.
- 3. Pruning the hedges. The background hedges must be pruned at a regular basis to form a cubicle shape and to create a blank and vertically flat backdrop. HC

Landscape Architect's contact: symbios@streamyx.com

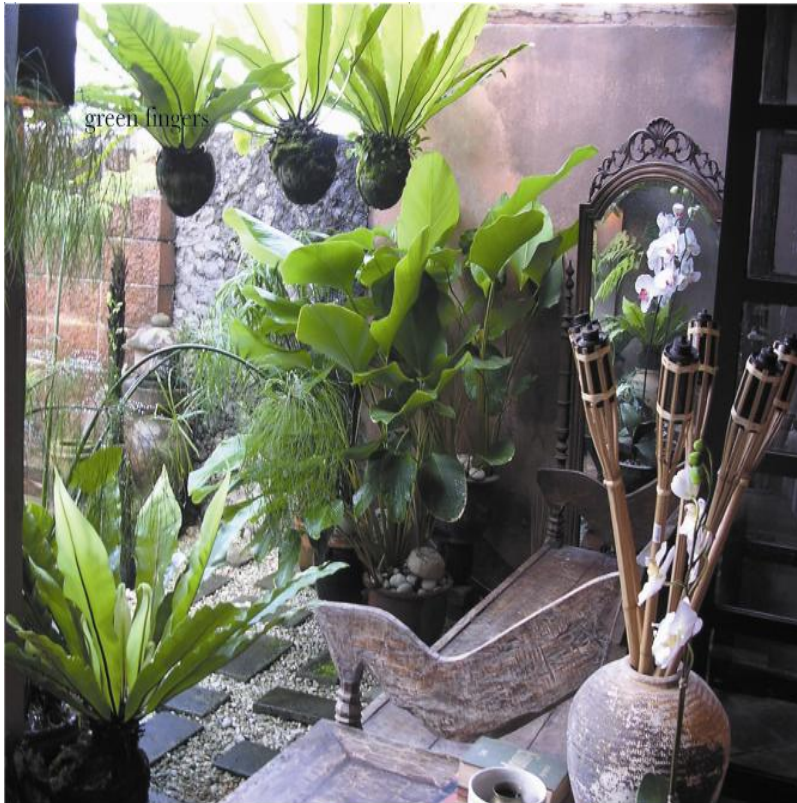

green fingers

Prettily Petite

Crave for that green haven even when you only have a small plot of garden? Find out how you can fully utilise limited spaces.

TEXT: TONG CHUN THING PHOTOS & CONTRIBUTING IDEAS: COURTESY OF SYMBIOSIS DESIGN

Living in a tropical climate, we often find ourselves engulfed in passionate greens. Green fingers or not, a little part of everyone craves for that tiny patch of garden, be it in a simplistic Zen tranquillity or in a fervent fashion of Balinese haven.

Somewhere you can twiddle your fingers in fresh soil and prune that stray branch or lovingly pluck out the weeds around your plants. It's a luxury to be so near to nature and we are frequently stumped when we are stuck with a little less than we imagined when it comes to garden size. So how do you fully exploit your small plot of land into picture perfect?



green fingers

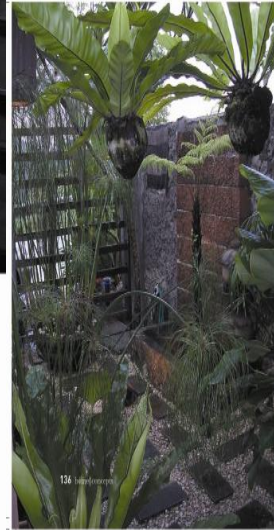

136 | homeconcept

Current popular concepts for the young and hip are Contemporary Tropical, Zen and Minimalist or a hybrid of the three. The older generation opt for Resort, Tropical and Balinese concepts.

Looking Ahead - Year 2006

As Malaysians get more and more aware of the importance of greens, the younger generation especially looks forward to surrounding their home and family in a green lung amidst the jungle of concrete in the city. Those who can afford it are getting their smaller plants replaced by more mature plants. They want their children to grow up in a greener surrounding and even those who stay in apartments and condominiums are implementing indoor gardens to fresh up the space.

Newer and innovative designs for gardening gadgets are also mushrooming all over the market with features to lessen the burden of maintenance work by demand of home owners and garden lovers.

Creative Breakthrough

Brighten your little garden space with your own special devis. Features that are products of your own creative DIY mind or any interesting pieces you pick up when you shop. For example, an old pot can be used as an aquatic plant pot or a water feature. Just explore beyond the ordinary and you will find yourself 'loving' in a garden you can be proud of one fine day. Landscape architect's contact: Symbiosis Design. Email: symbio@streamyx.com



Styles & Sensibility

When it comes to deciding a certain style for your garden, your preferences and personality bear precedence. Whether you are an outdoor or indoor person, a lazy or hardworking gardener generally decides the style that suits you most. Many create gardens for various purposes. Ask yourself if your garden is merely for blocking out the afternoon sun, for Feng Shui purposes, to provide more privacy or that you just enjoy green spaces.

Try to take into consideration safety precautions as well if you have active children running around the house. Will you favour an active or passive garden? Having pets in the house also affects your preference of plants in your garden.

Foliage Favourites

"We are lucky to be in a tropical climate," adds Khoo of Symbiosis Design. Our choices range from tropical to sub-tropical plants, flowering or non-

flowering, aquatic or non-aquatic, foliage or herd and even cactuses. These selections are influenced by the owner preference and the level of maintenance required.

Planting combination in small spaces like terraces usually employs the layering method, which not only creates depth of space but also further enhances the sense of spaciousness by applying 2 to 3 layers of plants with varying heights and suitable colour grouping.

Decorative items such as sculptures are the perfect break for monotony of a garden but bear in mind the massing of the ornaments and consider the blending effect in terms of integration of colour and texture.

Example 1: *Heliconia* exists as the background, *Bougainvillea* for the intermediate planting and *Palms* *Pyras* as the skirting or front ground cover.

Example 2: *Golfina* Grass for the intermediate planting, *Homoglyphis* as ground cover and river pebbles as the framing to embrace the cluster.

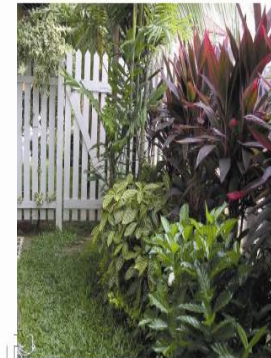



Par for the course

Spacious interiors and luxurious fittings ensure the Super 3-Storey Fairway Villas at Villa Green 3A are fully equipped for the high life

With our crowded cities and busy urban lifestyles, it has been said that space is the ultimate luxury today. However, finding a new home that can comfortably accommodate several generations of one family, and is large enough for entertaining, has become ever more difficult – until now.

The new Super 3-Storey Fairway Villas at Villa Green 3A, at the heart of the

These pages: Semi-detached luxury homes at Villa Green 3A in Petaling Jaya are adjacent to two

prestigious Petaling Jaya neighbourhood of Damansara Indah Resort Homes, and next to the award-winning Tropicana Golf and Country Resort, have been designed to fulfil this brief. Developed by Damansara Impian, a joint venture company comprising the Dijaya Group and PKNS, the new villas reflect an emphasis on space – both inside and out.

The villas overlook the Tropicana Golf

golf courses. Residents receive complimentary membership of the Tropicana Sports & Leisure Club.



No.	PROJECT LIST	CATEGORY	YEAR COMPLETED	CLIENT	LANDSCAPE COST
1	Suria Damansara	Condominium	2005	Martoz Corporation Sdn. Bhd.	1.2 Mil
2	Sri Pinang Apartment , Serdang	Condominium	2004	Fernpark Sdn. Bhd.	800k
3	Jln SS 23/27, Tmn SEA Petaling Jaya Street Up-Grading Works	Road	2004	Persatuan Buddhist Cempaka	100k
4	Prima Pelangi, Segambut Dalam	Mix Development	2005	Harmony Property Sdn. Bhd.	1.5 Mil
5	Puchong Hartamas Apartment, Puchong	Apartments	2005	Capital Land Sdn. Bhd.	600k
6	Merchant Square 32, Tropicana	Commercial	2006	Tropicana Golf and Country Resort Berhad.	800k
7	Ampang Boulevard, Ampang	Condominium	2007	Suditasia (M) Sdn. Bhd.	1.5 Mil
8	Sutera Jalil 2.5 sty terrace, Bandar Bukit Jalil	Gated terrace	2005	Bukit Jalil Development Sdn. Bhd.	800k
9	Access Road for Bandar Bukit Jalil	Road	2005	Bukit Jalil Development Sdn. Bhd.	200k
10	Penerbit Pelangi S/B Factory & Office, Kajang	Factory Office	2004	Pelangi Publisher Sdn. Bhd.	300k
11	Taman Hussein Terrace, Pahang DM	Terrace	2006	Sri Bistari Sdn Bhd.	-
12	Imbi Chapel, Jln Imbi	Chapel	2005	Imbi Chapel Committee	-
13	Fuji Electric Administration Office and factory, Kulim	Factory Office	2006	Fuji Electric Sdn. Bhd.	-
14	Subang Alam Show unit (Bungalow), Subang	Show Unit	2006	Subang Alam Sdn Bhd	150k
15	Posmmit Steel Factory, Klang	Factory Office	2007	Posmmit Steel Centre Sdn Bhd.	200k
16	Sri Carcosa Phase 2 Show House, Seremban 2	Show Unit	2008	RB Land Berhad	200k
17	The Heron Residency for Puchong.	Condominium	2008	Trinity Tower S/B	1.2mil
18	Villa Green, Damansara Indah, Tropicana.	Guarded Semi D/Banglo	2008	Dijaya Corp	1.1mil
19	Perdana Lakeview East , Cyberjaya	Guarded Banglo	2008	Setia Haruman Sdn Bhd	600k
20	Perdana Lakeview West, Cyberjaya	Guarded Banglo	2008	Setia Haruman Sdn Bhd	600k
21	Safron Residence, Seremban 2	Show Unit	2009	RB Land Berhad	500k
22	Sentul Murni Apartment	Condominium	2009	Sentul Murni Sdn Bhd	800k
23	Shah Alam 2, Fasa 5A2 & 5A3, Bukit Cerakah	Mix Development	2009	RB Land Berhad	800k
24	Mr. See's Bungalow, Banting.	Bungalow	2009	Mr. See	500k
25	Wong Szi Meng's Resident, Tmn Yarl	BUngalow	2009	Mr. Wong Sze Meng	200k
26	Casa Indah (Phase 2)	Condominium	2009	Dijaya Corp	1.5 mil

PROJECT LISTS

No.	PROJECT LIST	CATEGORY	YEAR COMPLETED	CLIENT	LANDSCAPE COST
27	Bayu Sri Bintang, Gombak	Guarded Semi D/Banglo	2009	IJM Land Berhad	800k
28	Bayu Segar, Cheras	Guarded Semi D/Banglo	2009	IJM Land Berhad	1 mil
29	PT19 Residency, Puchong	Guarded 0-Lot	2009	Trinity Tower S/B	300k
30	Tan Sri K.K.Chai Resident, Mines Serdang	Bungalow	2009	Tan Sri K.K Chai	200k
31	Philea Resort & Spa, Ayer Keruh	Resort	2009	Philea Group	30 mil
32	MK3, Mont Kiara	Condominium	2009	HR United	1 mil
33	Taman Tasik Prima	Upgrading Amenities	2009	Bolton Berhad	200k
34	Ukay Boulevard, Ampang	Commercial	2009	Ukay Boukleaveverd S/B	500k
35	D'impian Tropika ,Kota Damamsara.	Guarded	2009	D'impain Tropika S/B	600k
36	Taman Ilmu, Shah Alam	Mix Development	2010	Ikram Ikhlas S/B	2 mil
37	Damai Apartment, Shah Alam	Apartment	2010	Ikram Ikhlas S/B	1 mil
38	The Senderson Apartment	Condominium	2010	Condominium	1.5 mil
39	Upgrading Works for Wisma Consplant	Commercial	2010	Khazanah Berhad	3.6 mil
	<u>On Going Project</u>				
40	Kajang Walk, Kajang	Commercial		Metro Kajang Group	2 mil
41	Pelangi Semenyih 2, Semenyih	Mix Development		Metro Kajang Group	3.6mil
42	Sentosa Height	Gated Semi-D		Metro Kajang Group	800k
43	Saville @ Melawati, Melawati	Mix Development		Metro Kajang Group	1.5mil
44	Park Avenue 1120, PJ	Condominium		Peter's Brick Work Holding S/B	3.6mil
45	Central Residency, Sg Besi	Mix Development		HR United S/B	2mil
46	North Garden & 18 Edge, Selayang	Mix Development		Symphony Radiant S/B	1.5mil
47	Pertama Condominium, Tmn Pertama	Condominium		TA Group	500k

PROJECT LISTS